

ITEM I.D. (BRASS)	ITEM I.D. (CHROME)	TUBE SIZE		STRAIGHT THREAD		DIM 'A'	DIM 'B'	DIM 'C'
		1	2	1	2			
65-2 B	-	1/8	1/8	5/16-24	5/16-24	.61	.61	.094
65-3 B	-	3/16	3/16	3/8-24	3/8-24	.61	.61	.125
65-4 B	-	1/4	1/4	7/16-24	7/16-24	.60	.60	.188
65-5 B	-	5/16	5/16	1/2-24	1/2-24	.67	.67	.250
65-6 B	65-6 C	3/8	3/8	9/16-24	9/16-24	.73	.73	.312
65-7 B	-	7/16	7/16	5/8-24	5/8-24	.88	.88	.312
65-8 B	65-8 C	1/2	1/2	11/16-20	11/16-20	.92	.92	.407
65-8-6 B	65-8-6 C	1/2	3/8	11/16-20	9/16-24	.94	.88	.312
65-10-6 B	65-10-6 C	5/8	3/8	13/16-18	9/16-24	.80	.77	.323
65-10-8 B	65-10-8 C	5/8	1/2	13/16-18	11/16-20	.81	.78	.531
65-10 B	65-10 C	5/8	5/8	13/16-18	13/16-18	1.04	1.04	.500
65-12 B	-	3/4	3/4	1-18	1-18	1.19	1.19	.625
65-14 B	-	7/8	7/8	1-1/8-18	1-1/8-18	1.25	1.25	.750

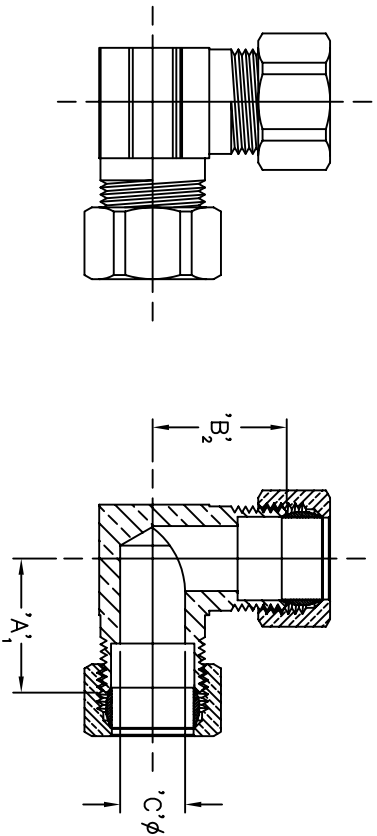

This drawing and all data contained herein is the confidential and exclusive property of BrassCraft Manufacturing, and shall not be disclosed to others without the written consent of BrassCraft. This drawing must be returned to BrassCraft if requested.

BrassCraft
 A Masco Company
 NOVIL MICHIGAN
 ALL OUR PRODUCTS MEET Y14.8M CLASSIFICATION OF QUALITY LEVELS
 CLASS SYMBOL
 STPQ (KEY PRODUCT CHARACTERISTICS)
 STPQ (STANDARD PRODUCT CHARACTERISTICS)
 PRODUCT WARNINGS

DESCRIPTION COMPRESSION ELBOWS (SUBMITTAL)		DRAWING NO. CFE0202B	
DRAWN PERNAK 01/25/2005	DATE 01/25/2005	MATERIAL	ITEM DESCRIPTION 65-2
CHK'D. Klimke 02/10/2005	DATE 02/10/2005	VOLUME	ITEM ID 65-2 B
APPR'D.	DATE		SEE CHART
NOTE: UNLESS OTHERWISE SPECIFIED TWO PLACE DECIMALS THREE PLACE DECIMALS		+	SCALE (UNLESS NOTED) FULL
ANGULARITY		B SIZE	UNITS INCH
			REV. B