

STEP #1: CONNECTOR LENGTH W/NUTS

NOM. LGTH. SEE STEP #2/#3	LENGTH
12	10.23/10.98
18	16.23/16.98
24	22.23/22.98
30	28.23/29.48
36	34.23/35.48
48	46.23/47.48
60	60.23/61.98
72	70.23/71.98

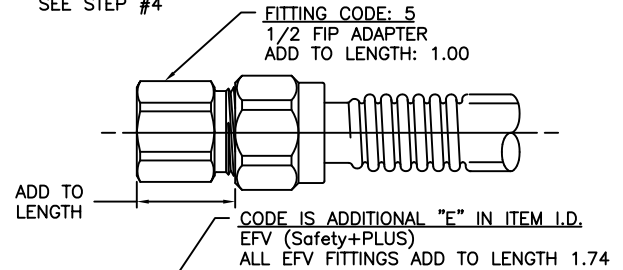
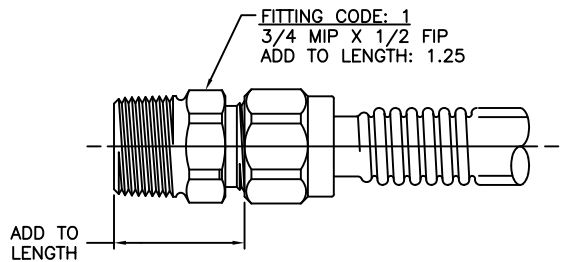

STEP #2/STEP #3: FITTING CODE

CSSC ## E-12",18",24",30",36",48",60",72"

NOMINAL LENGTH
EFV (SEE NOTES)

FITTING CODES
1/2" I.D. (5/8" O.D.) CONNECTOR
STAINLESS STEEL
COATED CONNECTOR

NOT ALL COMBINATIONS ARE VALID PART NUMBERS
CHECK CATALOG FOR DETAILS

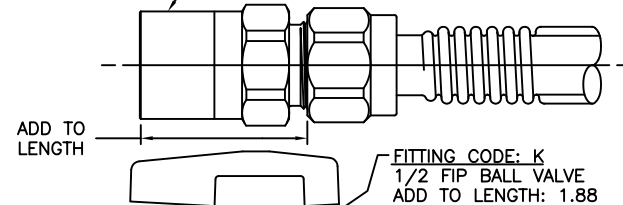
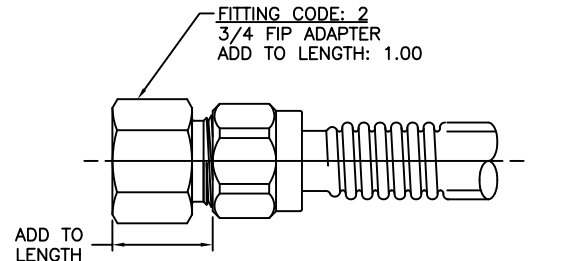

STEP #4: OVERALL LENGTH

FITTING CODE (STEP #2)
+ CONNECTOR LENGTH W/NUTS (STEP #1)
+ FITTING CODE (STEP #3)
= OVERALL LENGTH

EXAMPLE #1: CSSC54-12
CONNECTOR LENGTH W/NUTS: 10.23/10.98
1/2 MIP ADAPTER (FITTING CODE 4): 1.25
1/2 FIP ADAPTER (FITTING CODE 5): 1.00
OVERALL LENGTH EQUALS: 12.48/13.23

EXAMPLE #2: CSSC54E-12
CONNECTOR LENGTH W/NUTS: 10.23/10.98
1/2 FIP EFV (FITTING CODE E): 1.74
1/2 MIP ADAPTER (FITTING CODE 4): 1.25
OVERALL LENGTH EQUALS: 13.22/13.97

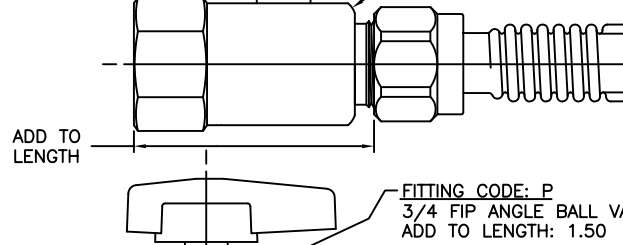
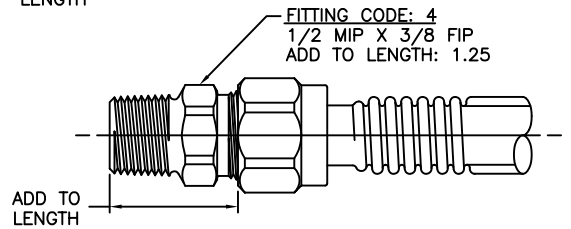
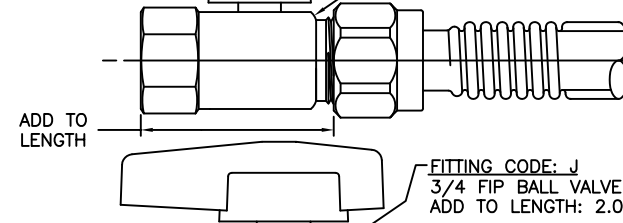
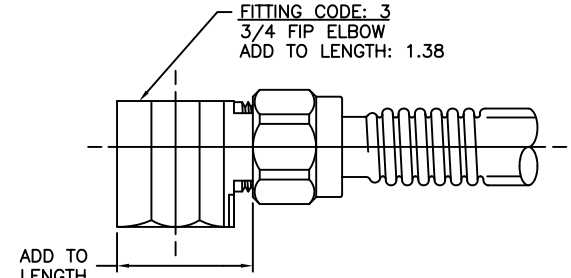

- NOTES:**
- 1/2 NOMINAL GAS CONNECTOR FITTING ADAPTERS & VALVES ARE ALL 5/8 FLARE WITH 15/16-16 THREAD.
 - A GAS CONNECTOR ASSEMBLY CONSIST OF THE CORRUGATED TUBING AND TWO UNION FITTINGS. AN EXCESS FLOW VALVE (EFV) OR GAS SHUT OFF VALVE MAY BE SUBSTITUTED ON THE INLET. CONNECTORS WITHOUT FITTINGS (FITTING "NN") ARE SOLD AS "NON" CERTIFIED PRODUCT.

This drawing and all data contained herein is the confidential and exclusive property of BrassCraft Manufacturing, and shall not be disclosed to others without the written consent of BrassCraft. This drawing must be returned to BrassCraft if requested.

<p>BrassCraft A Masco Company NOVI, MICHIGAN</p>	DESCRIPTION	1/2 NOM ID GAS CONNECTORS OVERALL LENGTHS (SUBMITTAL)	DRAWING NO.	GPA0314C
	DRAWN	KLIMKIE	DATE	08/06/2003
	CHK'D.	Schutte	DATE	01/02/2007
	APP'D.		DATE	
ALL GGT PER ANSI STD Y14.5M CLASSIFICATION OF QUALITY LEVELS		MATERIAL ITEM DESCRIPTION CSSCXX-XX		REV. C
KPC (KEY PRODUCT CHARACTERISTICS)		VOLUME ITEM ID CSSCXX-XX		UNITS INCH
STPC (STANDARD PRODUCT CHARACTERISTICS)		NOTE: UNLESS OTHERWISE SPECIFIED TWO PLACE DECIMALS ±.005 THREE PLACE DECIMALS ±.001 ANGULARITY		SCALE FULL
PRODUCT MARKINGS		SIZE		REV.