

(B)

LET.	DATE	PER	BY	CHANGE
A	10/01/02	WFT	KAK	RELEASE
B	2/26/03	WFT	MJP	REVISED CHART

ITEM I.D.	ITEM DESC.	DIMENSION "A"
1-12A A	1-12A	11.63
1-12A C	1-12A	11.63
1-12A P	1-12A	11.63
1-12A R	1-12A	11.63
1-15A C	1-15A	14.63
1-15A P	1-15A	14.63
1-15A R	1-15A	14.63
1-20A A	1-20A	19.63
1-20A C	1-20A	19.63
1-20A P	1-20A	19.63
1-20A R	1-20A	19.63
1-30A A	1-30A	29.63
1-30A C	1-30A	29.63
1-30A P	1-30A	29.63
1-30A R	1-30A	29.63
1-36A C	1-36A	35.63
1-36A P	1-36A	35.63
1-36A R	1-36A	35.63

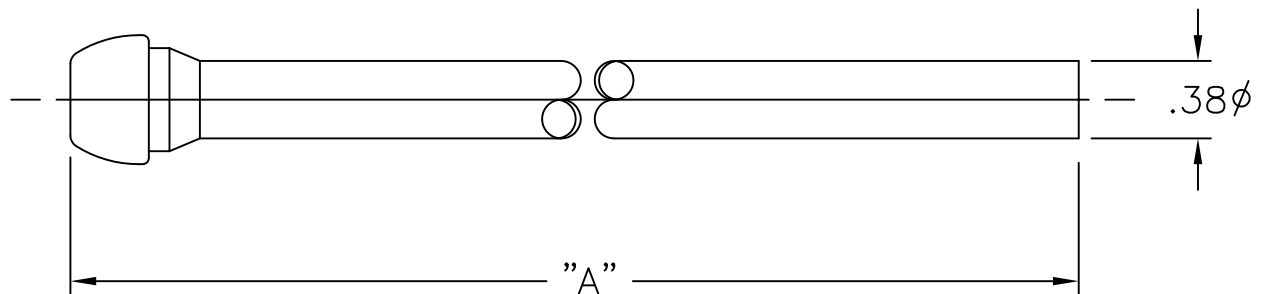

DESCRIPTION 3/8 O.D. FAUCET RISER TUBE (SUBMITTAL)		DRAWING NO. RPG0094B	
DRAWN KLIMKIE	DATE: 10/01/2002	MATERIAL	ITEM DESCRIPTION 1-12A SEE CHART
CHK'D. KAK	DATE: 03/31/2003	VOLUME	ITEM ID 1-12A C SEE CHART
APP'D.		DATE:	
NOTE: UNLESS OTHERWISE SPECIFIED TWO PLACE DECIMALS THREE PLACE DECIMALS ANGULARITY		UNITS INCH	SCALE: (UNLESS NOTED) FULL
CLASS SYMBOL		SIZE	REV. B

This drawing and all data contained herein is the confidential and exclusive property of BrassCraft Manufacturing, and shall not be disclosed to others without the written consent of BrassCraft. This drawing must be returned to BrassCraft if requested.

CLASS	SYMBOL
KPC (KEY PRODUCT CHARACTERISTICS)	◇
STPC (STANDARD PRODUCT CHARACTERISTICS)	△
PRODUCT MARKINGS	○