

LET.	DATE	PER	BY	CHANGE
A	9/14/98	WFT	GAT	RELEASE FOR PRODUCTION
B	7/26/02	JPS	MJP	REVISED CHART
C	2/26/03	WFT	MJP	REVISED CHART

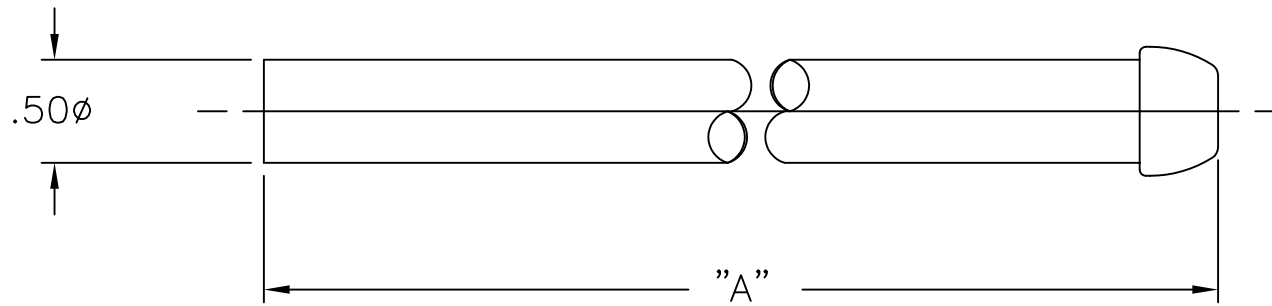

(B) (C)

ITEM I.D.	ITEM DESC.	DIMENSION "A"
3-12A C	3-12A	11.56
3-12A R	3-12A	11.56
3-15A C	3-15A	14.56
3-20A C	3-20A	19.56
3-20A P	3-20A	19.56
3-20A R	3-20A	19.56
3-30A C	3-30A	29.56
3-30A R	3-30A	29.56
3-36A C	3-36A	35.56
3-36A R	3-36A	35.56



NOVI, MICHIGAN

ALL GDT PER ANSI STD Y14.5M  
CLASSIFICATION OF QUALITY LEVELS

CLASS	SYMBOL
KPC (KEY PRODUCT CHARACTERISTICS)	◇
STPC (STANDARD PRODUCT CHARACTERISTICS)	△
PRODUCT MARKINGS	○

DESCRIPTION 1/2 O.D. FAUCET RISER TUBE (SUBMITTAL)		DRAWING NO. RPG0092C	
DRAWN THOMAS	DATE: 09/14/98	MATERIAL	ITEM DESCRIPTION 3-12A SEE CHART
CHK'D. Klimkie	DATE: 04/04/2003	VOLUME	ITEM ID 3-12A C SEE CHART
APP'D.	DATE:	NOTE: UNLESS OTHERWISE SPECIFIED TWO PLACE DECIMALS +/- .010 THREE PLACE DECIMALS +/- .005 ANGULARITY +/- 1°	UNITS INCH
		SCALE: (UNLESS NOTED) FULL	REV. C

This drawing and all data contained herein is the confidential and exclusive property of BrassCraft Manufacturing, and shall not be disclosed to others without the written consent of BrassCraft. This drawing must be returned to BrassCraft if requested.